



HouseSmart®

INSTALLATION INSTRUCTIONS

HomeTouch

These instructions will walk you through how to install your HomeTouch Graphic. Use this QR code to watch an installation video for these graphics.



TOOLS YOU'LL NEED:

- Drill
- 5/32" drill bit
- Level
- Measuring tape
- Masking or painters tape

WALL OUTLET REQUIRED BEFORE INSTALLATION:

Your HouseSmart Icon includes led lighting that provides an energy efficient halo lit effect around the hexagon shape. You will need to have an electrician install a standard outlet before you install these graphics, if your office doesn't already have the outlet installed upon delivery. Please refer to the last page of this document for specs on placement of your outlet.

Installation Location

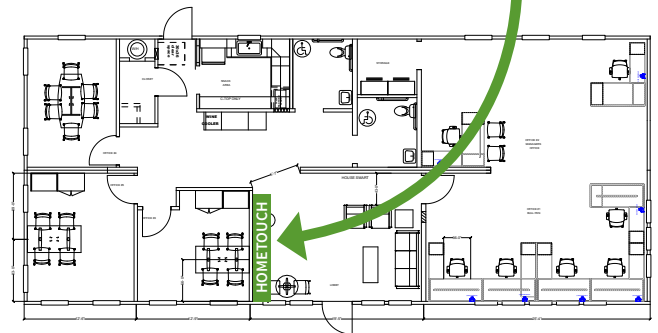

***Placement & measurements may vary in remodeled offices**

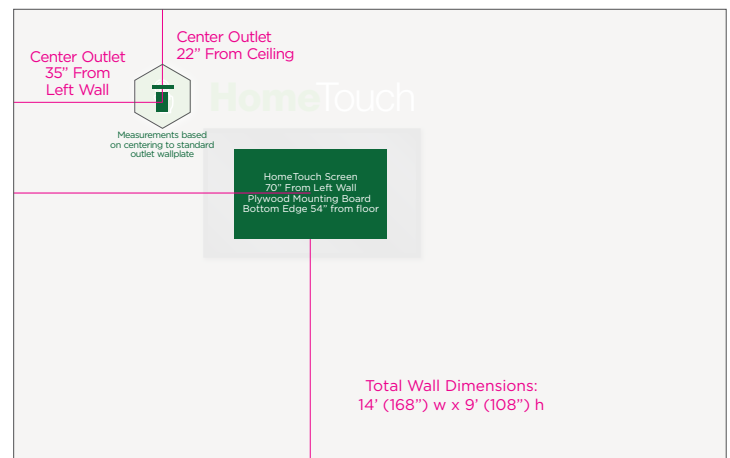

1

Position Template



Center the graphic template using the electrical outlet and HomeTouch screen position as your guide.

There are guides on the template that should line up with the top left corner of the screen, and with the hexagon shape should completely cover up the outlet.

Once your template is in the right position, use masking or painters tape to secure it in place. Make sure template is flat against the wall.

2**Confirm Template Position**

With your templates installed, step back and look things over before drilling any holes. If everything looks centered and level, gather your tools to complete the installation.

3**Drill Holes**

Starting with a 5/32" drill bit, drill through each of the stud markers on the graphic.

After all the holes are drilled, you can take down and discard the template.

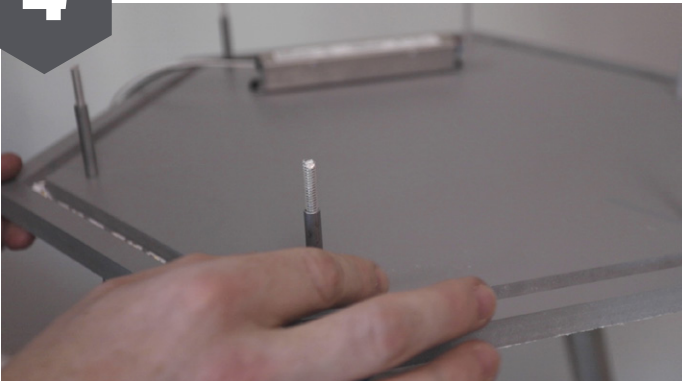
4**Place space sleeves**

Before installing the HomeTouch lettering and Icon, slide the 1.5" spacer sleeves over each stud to keep the graphics from being flush against the wall.

5**Install Hexagon Icon**

Starting with the hexagon icon, remove the protective mask from the graphic, plug the cable into the outlet, and press into the pre-drilled holes. Use a fist to gently seat to the wall.

6

Install Wall Anchors & Screws



Continue with each letter (or letter set) by first removing the protective mask, pressing into the pre-drilled holes, and using a fist to gently seat to the wall.

7

Install Barrels & Threaded Rods



Step back and admire your new HomeTouch graphic.

NEED HELP?

Contact us at CMHMarket@HighResolutions.com for any of the below reasons:

Missing Parts/Pieces

Broken/Damaged Graphics

Questions about Installation

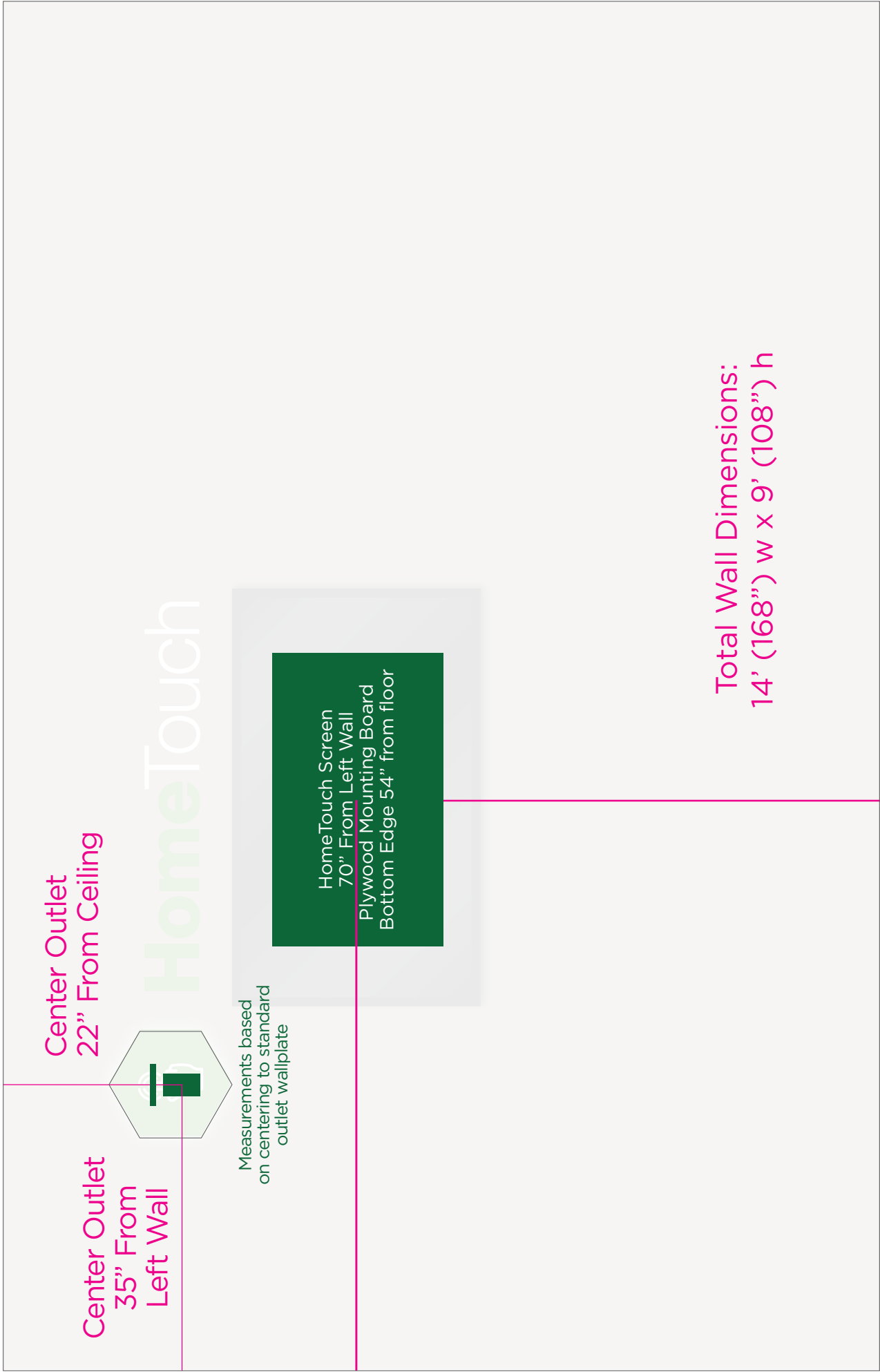

***Placement & measurements may vary in remodeled offices please contact Retail Marketing for updated measurements.**